







**EVINRUDE
Johnson**



DUAL CABLE STEERING BRACKET KIT, P/N 5005819 INSTALLATION INSTRUCTIONS

This kit can be used on all 90/115/140 HP *Johnson* 4-Stroke outboards and 2002 or newer 60/70 HP *Johnson* 4-Stroke outboards.

For safety reasons, this kit must be installed by an authorized *Evinrude/Johnson* dealer. These installation instructions contain information that can help prevent personal injury and damage to equipment. Understand the following symbols before proceeding:

	DANGER	
Indicates an imminently hazardous situation which, if not avoided, WILL result in death or serious injury.		

	WARNING	
Indicates a potentially hazardous situation which, if not avoided, CAN result in severe injury or death.		

	CAUTION	
Indicates a potentially hazardous situation which, if not avoided, MAY result in minor or moderate personal injury or property damage. It also may be used to alert against unsafe practices.		

IMPORTANT: Identifies information that will help prevent damage to machinery and appears next to information that controls correct assembly and operation of the product.

Although the mere reading of such information does not eliminate the hazard, the understanding and application of the information will promote the correct use of your outboard engine.

TO THE OWNER

The assembly procedures outlined in this sheet should be performed by a skilled technician. If you have questions, see your DEALER. Save these instructions in your owner's kit. This sheet contains information important to the future use and maintenance of your engine.

TO THE INSTALLER

Give this sheet to the owner. Advise the owner of any special operation or maintenance information contained in the instructions. This kit is designed for specific applicable models only. It is not recommended for units other than those for which it was sold.



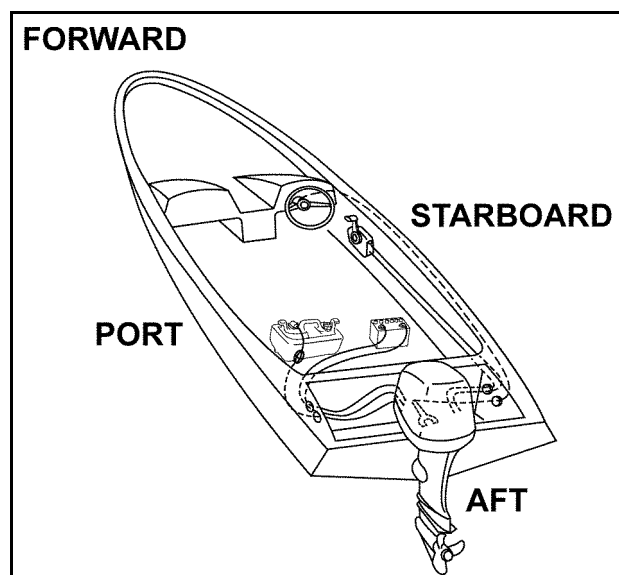

Nautical Orientation

CONTENTS OF DUAL CABLE STEERING BRACKET KIT

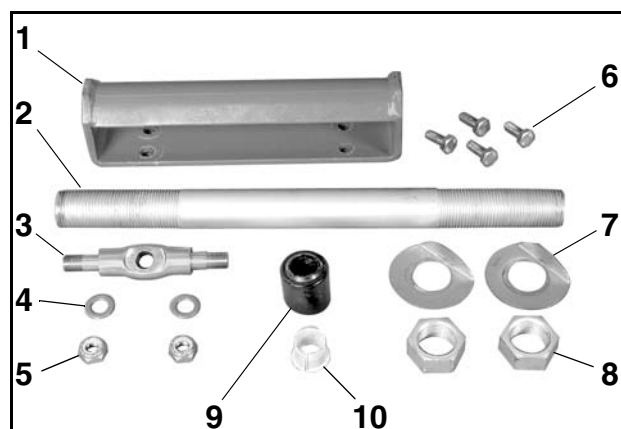

002363

Ref	Name of Part	Qty
1	CABLE MOUNTING BRACKET	1
2	CABLE SUPPORT TUBE	1
3	CABLE CONNECTOR	1
4	WASHER, Flat	2
5	LOCKNUT	2
6	SCREW, Mounting bracket	4
7	WASHER, Support tube	2
8	NUT, Support tube	2
9	SEAL, Steering cable	1
10	BUSHING, Support tube	1

⚠
CAUTION
⚠

Improper installation of this kit could result in personal injury due to loss of boat control. Follow this procedure carefully.

IMPORTANT: The steering link assembly mentioned in this procedure is included with the out-board. It is also available separately as a kit:

- **60/70 HP models:** P/N 5032844
- **90/115/140 HP models:** P/N 5033870

IMPORTANT: Both gear racks or rotary steering heads must be installed so both steering cables will be routed together on the same side of the boat and will push/pull together.

INSTALLING THE AFT STEERING CABLE (IF NECESSARY)

IMPORTANT: If not already installed, aft steering cable must be installed **before** mounting out-board on transom.

Turn steering wheel to extend steering cables to full length. Apply *Triple-Guard®* grease to steering cable ram, steering cable jacket, and end of steering cable.

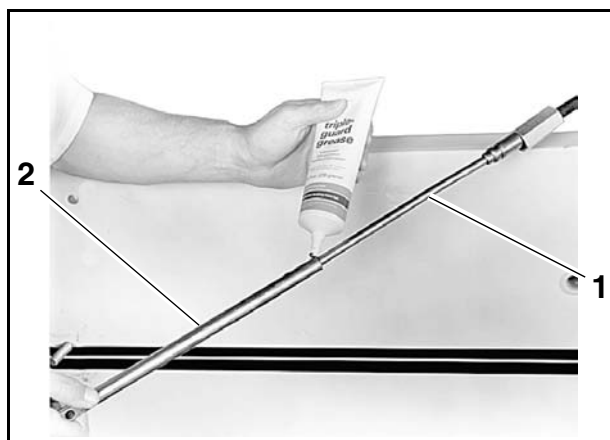

1. Steering cable ram
2. Steering cable jacket

5873

Install aft steering cable through tilt tube from starboard end. Tighten cable anchor nut to torque specified by steering cable manufacturer.



1. Tilt tube
2. Steering cable
3. Cable anchor nut

002366

INSTALLING THE STEERING LINK

Apply small amount of *Triple-Guard* grease to threads of steering link rod. Install cable connector onto threaded end of steering link rod with two (2) flat washers and locknut, as shown. DO NOT tighten locknut at this time.

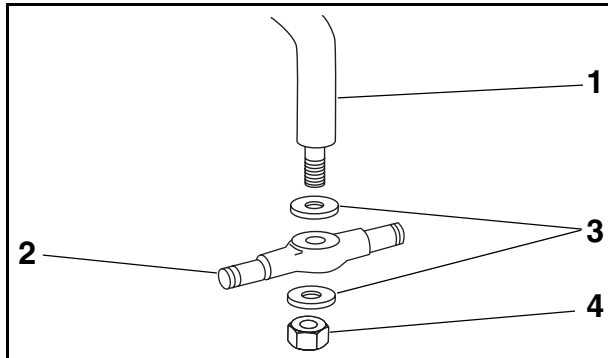

1. Steering link rod
2. Cable connector
3. Flat washers
4. Locknut

002365

Apply *Triple-Guard* grease to ends of steering link spacer. Install steering link rod to rear bolt hole of steering arm with spacer, flat washers, steering link screw, and locknut, as shown.

Tighten steering link screw to torque of 23 to 26 ft. lbs. (31 to 35 N·m). Hold screw with a wrench while tightening locknut to same torque.

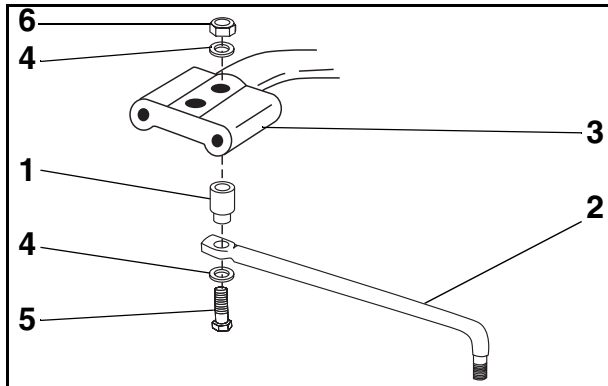

1. Steering link spacer
2. Steering link rod
3. Steering arm
4. Flat washer
5. Steering link screw
6. Locknut

002364

Attach aft steering cable to cable connector.

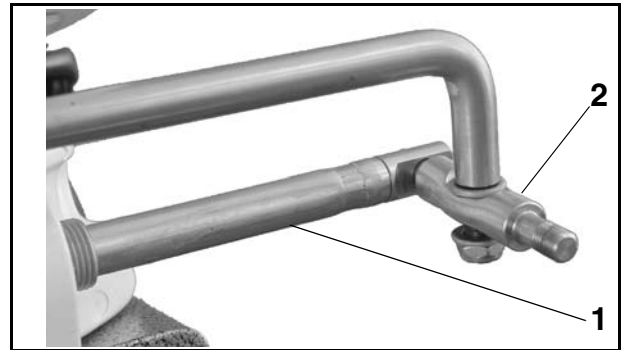

1. Steering cable
2. Cable connector

002367

INSTALLING THE FORWARD STEERING CABLE

Turn steering wheel to extend steering cables to full length. Apply *Triple-Guard* grease to steering cable ram, steering cable jacket, and end of steering cable.

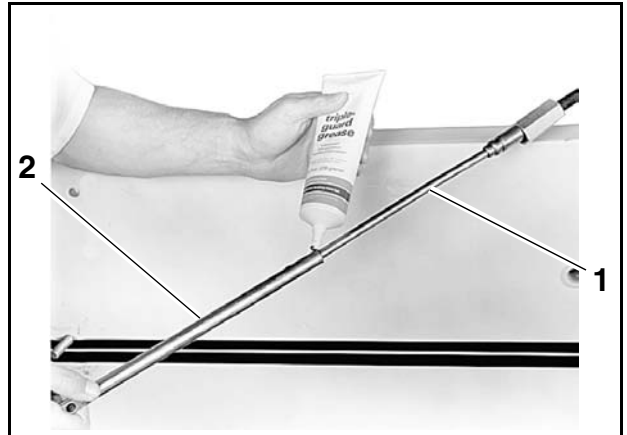

1. Steering cable ram
2. Steering cable jacket

5873

Install support tube washer and nut on one end of cable support tube. Install forward steering cable through support tube. Tighten cable anchor nut by hand.

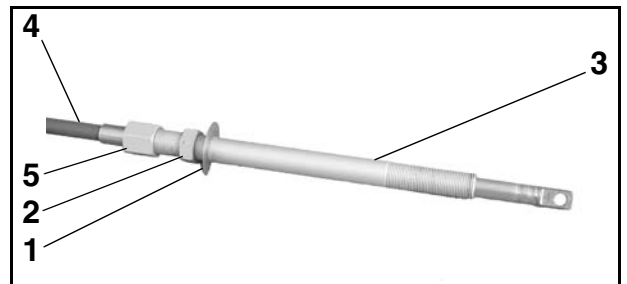

1. Washer
2. Nut
3. Cable support tube
4. Steering cable
5. Cable anchor nut

002368

Slide cable support tube and steering cable through cable mounting bracket. Install support tube washer and nut on other end of support tube. Tighten both support tube nuts against mounting bracket by hand.

Slide support tube bushing and steering cable seal onto steering cable, but NOT into or over support tube at this time.

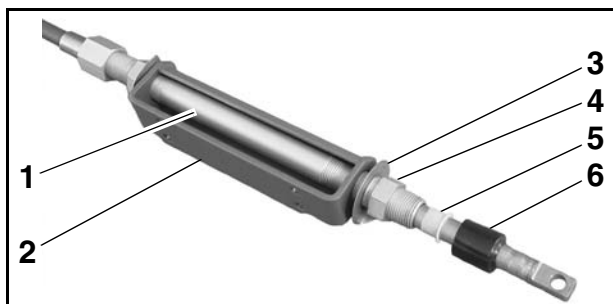

1. Cable support tube
2. Cable mounting bracket
3. Washer
4. Nut
5. Bushing
6. Steering cable seal

002369

Apply small amount of *Triple-Guard* grease to end of forward steering cable. Attach steering cable to cable connector.

Use a 1/4 - 28 thread chaser to remove paint from bolt holes in mounting boss.

Apply *Screw Lock*™ to threads of four (4) mounting bracket screws. Secure cable mounting bracket to mounting boss. Tighten screws to torque of 100 in. lbs. (11 N·m).

Hold support tube nut on **port side** with a wrench and tighten forward cable anchor nut to torque specified by steering cable manufacturer.

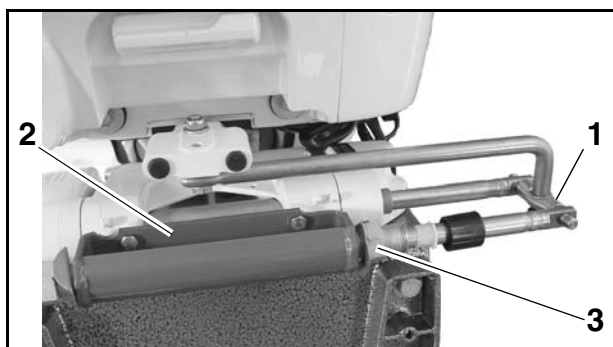

1. Cable connector
2. Cable mounting bracket
3. Support tube nut - port side

002370

Secure steering cables to cable connector with two (2) flat washers and locknuts. DO NOT tighten locknuts at this time.

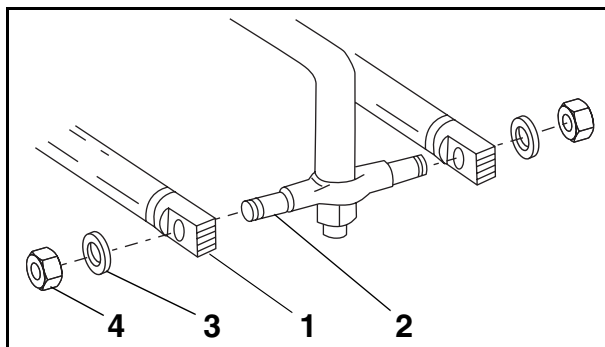

1. Steering cable
2. Cable connector
3. Flat washer
4. Locknut

002371

ADJUSTING THE FORWARD STEERING CABLE

Center the outboard. Loosen both support tube nuts by 10 turns. Position cable support tube in mounting bracket so ends of cable anchor nuts on both steering cables are even, as shown.

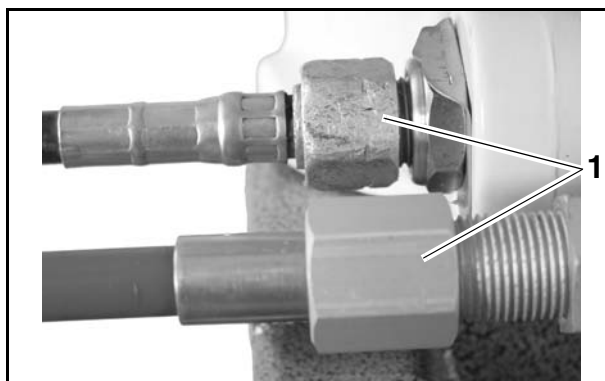

1. Cable anchor nuts - even

002372

Take up slack in steering cables by pushing outboard slightly in the direction of a starboard turn.

Slide cable support tube slightly toward port side to compensate for slack. Ends of cable anchor nuts should be slightly offset, as shown.

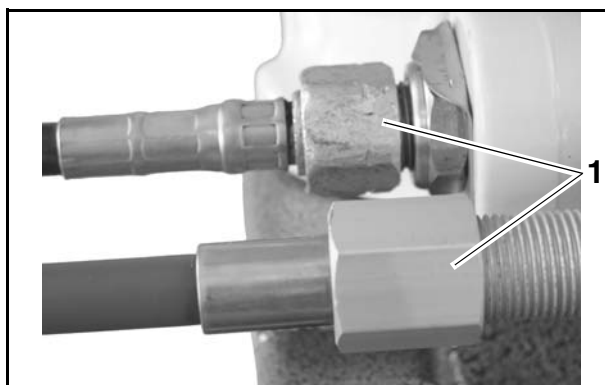

1. Cable anchor nuts - offset

002373

Tighten **port side** support tube nut finger tight against mounting bracket, then use a wrench to tighten it one additional turn.

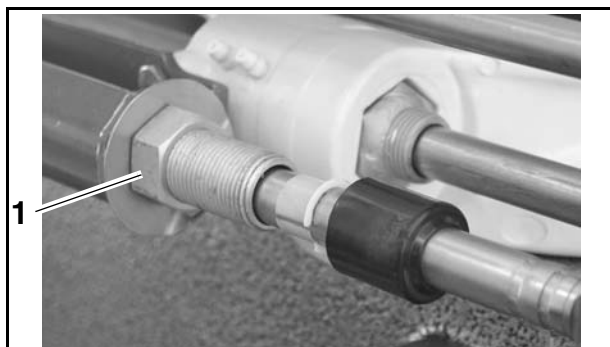

1. Support tube nut - port side

002375

Tighten **starboard side** support tube nut to torque of 35 ft. lbs. (47 N·m). Bend locking tabs on both support tube washers over nuts.

Tighten both cable connector locknuts to torque of 80 to 97 in. lbs. (9 to 11 N·m). Tighten steering link locknut to torque of 80 to 97 in. lbs. (9 to 11 N·m), then back it off by 1/4 turn.

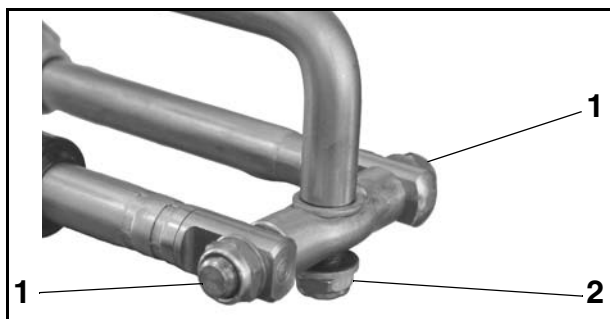

1. Cable connector locknuts
2. Steering link locknut

002374

Insert support tube bushing into end of support tube, then slide steering cable seal over end of support tube.

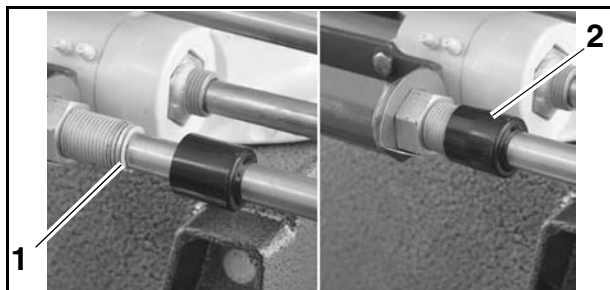

1. Support tube bushing
2. Steering cable seal

002375

Use the steering wheel to turn outboard through full steering range in both running and full tilt positions.

- If a delay in steering response is felt, there is too much slack in forward steering cable.
- If any binding is felt, forward steering cable is too tight.

Readjust steering cable until steering feels smooth and responsive.



CAUTION



Binding in the steering system reduces the operator's control of the boat. Operating the boat with steering cables that are too tight will damage and shorten the life of the steering system.

Check for possible interference between the steering system components and any portion of the outboard, boat, or accessories. Failure to correct interference could result in damage to or failure of the steering system and loss of boat control if the outboard strikes an underwater object.

MAINTENANCE

Check forward steering cable adjustment after initial 10 hours of use. Follow all maintenance recommendations in Operator's Guide.



CAUTION



Failure to lubricate steering cable rams as recommended could result in steering system corrosion, an increase in steering effort, and a reduction in the operator's control of the boat.



CAUTION



If outboard is removed from boat, save special locking-type screws and nuts and any special hardware.

When reinstalling the outboard, use only original fasteners and tighten to correct torques. Replace any locking-type fastener that has a weak locking feature. A definite resistance to turning must be felt. Replace only with authorized replacement parts.