



**EVINRUDE<sup>®</sup>**  
**Johnson<sup>®</sup>**



---

## **Four-way Fuel Valve Kit P/N 174506**

### **Safety Considerations**

The instructions will alert you to certain things you should do very carefully. If you don't you could . . .

- hurt yourself, or bystanders
- hurt boat operator, passengers
- damage the machinery

Safety symbol, , appears next to information to prevent you and others from being hurt.

Note symbol, , appears next to information important to keep machinery from being damaged.

**IMPORTANT:** The important safeguards and instructions appearing in these directions cannot cover all possible conditions or situations that occur. The person following these directions must use common sense, caution and care.

### **Product Reference & Illustration**

When reference is made to a brand name, product or specific tool, an equivalent product may be used in place of the referred to product. Substitute products used must have equivalent characteristics, including type, strength, and material. Incorrect substitution may result in product malfunction and possible injury to the operator and/or passengers.

All photographs and illustrations used may not necessarily depict actual models or equipment, but are intended only for reference. Specifications used are based on the latest product information available at the time of publication.

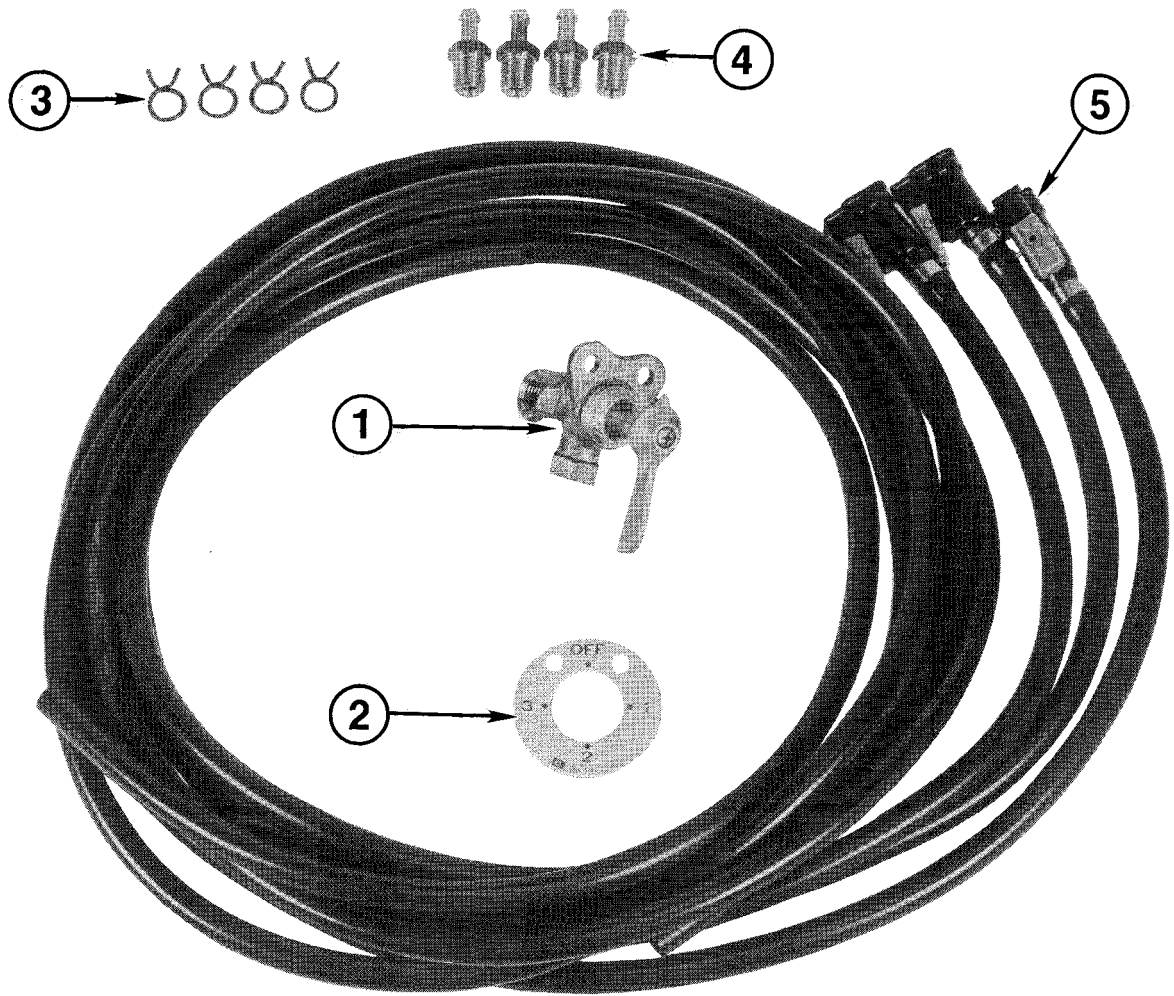

**1**

8747

**Preface**

The Four-way Fuel Valve Kit allows the use of three six-gallon fuel tanks with the added convenience of switching to any tank without disconnecting fuel lines. The fuel tanks still retain the quick disconnect feature and tanks may be placed in different positions for optimum weight distribution or removed from the boat for refueling.

A fuel hose with a primer bulb, fuel connector and primer bulb and fuel valve mounting hardware (not supplied) is required for this installation.

**1 Contents of Kit**

| Ref. | Name of Part             | Qty. |
|------|--------------------------|------|
| 1    | Four-way Valve .....     | 1    |
| 2    | Dial Plate .....         | 1    |
| 3    | Clamp .....              | 4    |
| 4    | Nipple .....             | 4    |
| 5    | Fuel Hose Assembly ..... | 3    |

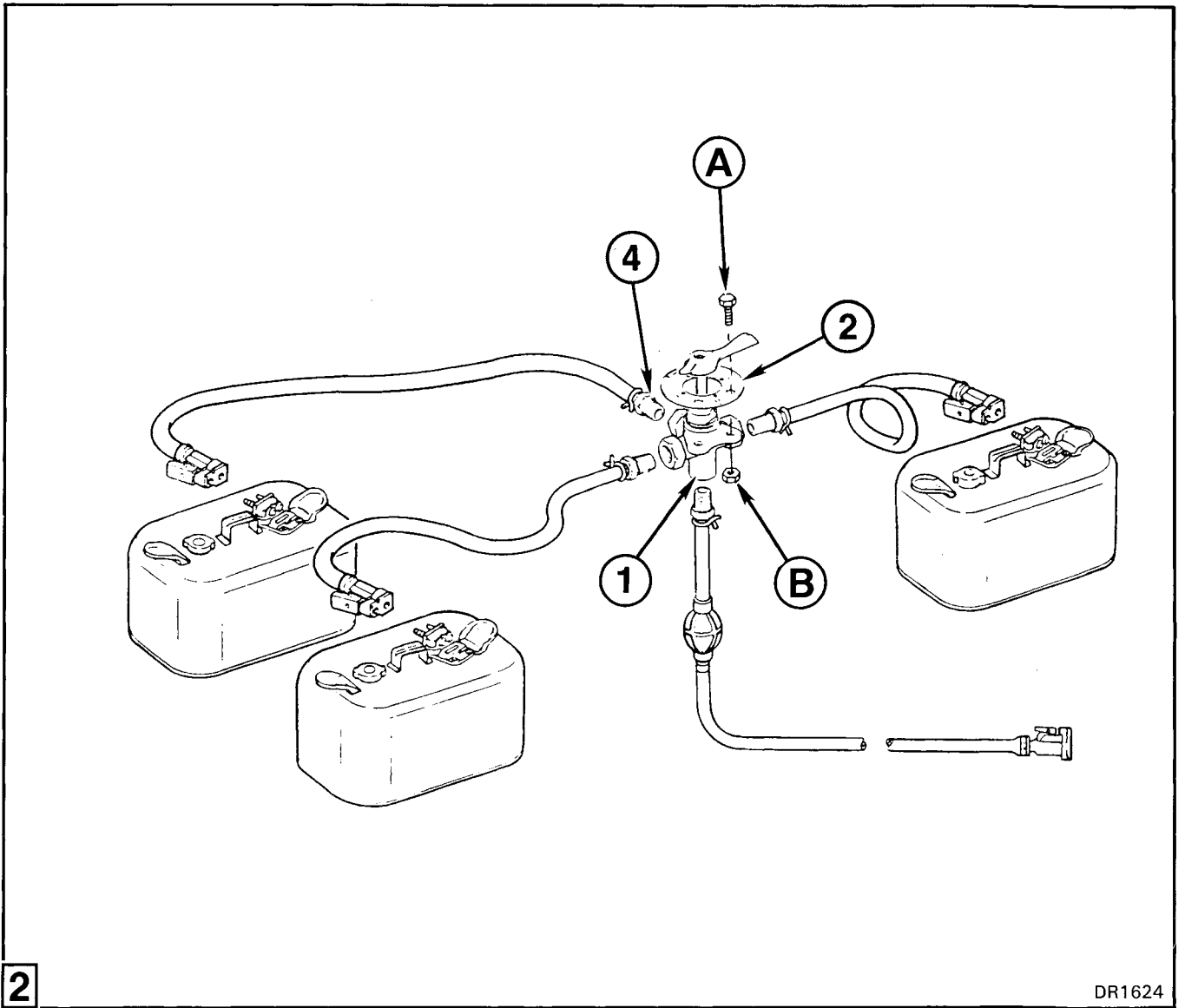

2

DR1624

### Installation

Select four-way valve mounting location. Mount the valve in any safe and convenient location within the limits of hose lengths. The mounting surface must not be thicker than 34,9 mm (1-3/8 in.) and there must be adequate clearance for valve body and hoses.

2 1. Use dial plate ② as guide for hole location. Use a center punch to mark hole centers. Drill one 28,5 mm (1-1/8 in.) hole and two 6,3 mm (1/4 in.) holes.

2 2. Apply a light even coat of *Pipe Sealant with Teflon* P/N 910048 to threads of nipples ④. Thread nipples into four-way valve. Tighten nipples securely.

2 3. Position four-way valve ① in mounting hole. Locate dial plate over mounting holes and secure using 6,3 mm (1/4 in.) screws A and nuts B (not provided).

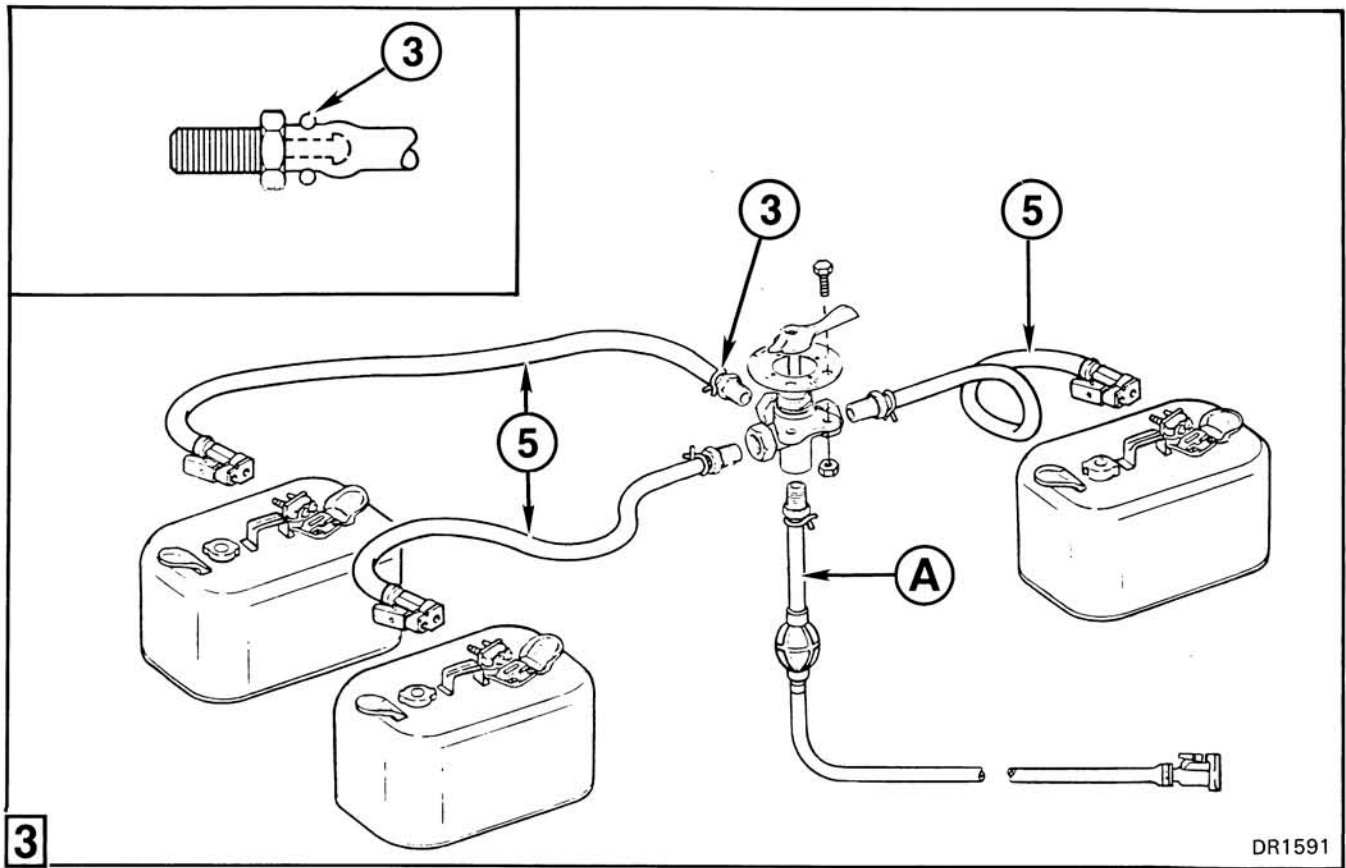

**3** 4. Remove and discard clamp and fuel connector at primer bulb end of fuel hose **A** (not provided).

**3** 5. Install clamp **3** onto three fuel hose assemblies **5** and fuel tank hose **A**.

**3** 6. Slide fuel hoses **5** and fuel tank hose **A** onto nipples **4** as shown in diagram. Slide clamps **3** into position to secure hoses at nipples.

**!** 7. Connect fuel tanks and fuel hose to motor. Squeeze primer bulb until firm. **Check all fuel connections for leaks.**

**!** To prevent possible fire and/or explosion, advise owner to turn four-way valve to OFF position when motor is tilted or when trailering.

**To the Installer:**

**!** Give these Installation Instructions to the future owner. The instructions contain safety warnings and other information vital to the continued safe use of this product.

**To the New Owner:**

Retain these Installation Instructions with your Owner's/Operator's manual. They contain installation and operating information for future reference.