

CD2 DIAGRAM

113-4488 and 113-4489

CD2 USL Conversion Kit Assembly

(FIG:2)

1. Remove the single charge coil from the timer base plate.
2. Remove original coil from the lamination.
3. Place the new high voltage coil P/N: 173-1670 onto the lamination post.
4. Bend the outer lamination to secure the coil to the lamination.
5. Install the new assembly back on to the plate. Use loctite to secure the bolts.
6. Route the lead wires for the electrical connections.

(Fig:1)

1. Remove flywheel.
2. Remove original CD2 USL from the timer base plate.
3. Mount the CDI sensor on the plate where the original CD2 USL was removed.
See diagram for proper mounting.
4. Set the air-gap according to the factory service manual using the CDI gauge P/N: 533-4994.
5. Secure the mounting screws using Loctite adhesive.
6. Route the lead wires for the electrical connections.

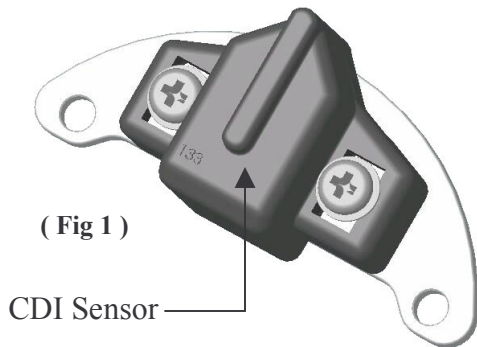

Specifications
Install (Fig: 2)

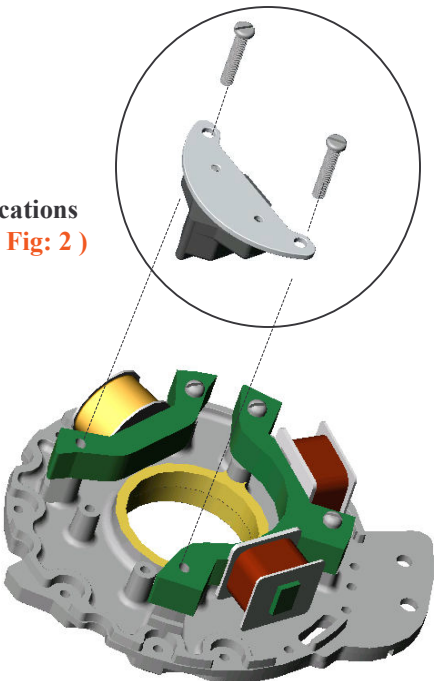

(Fig 2)

High voltage Coil

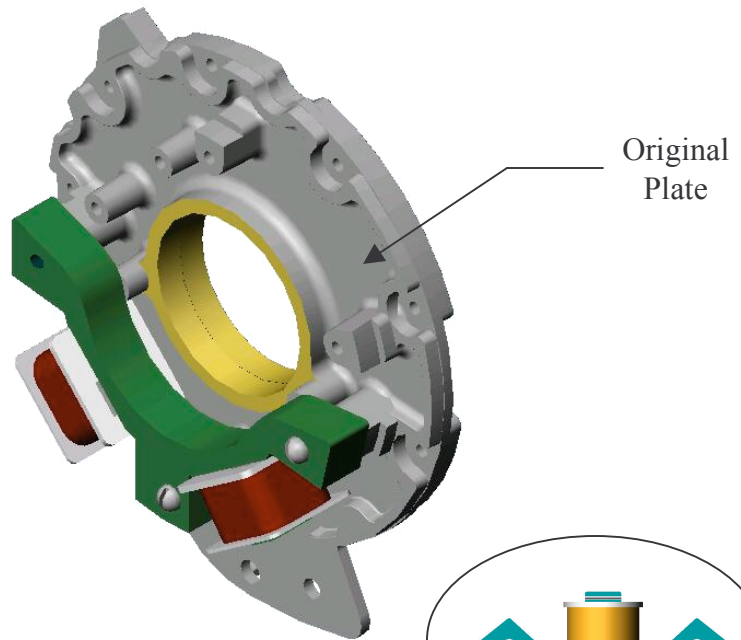
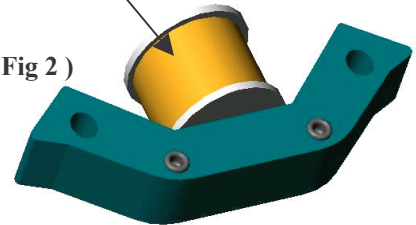

Specifications
Install (Fig: 1)

