

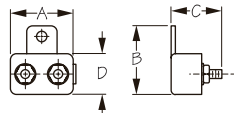

## RESETTABLE CIRCUIT BREAKER

*Stamped Brass/Injection Molded Nylon/Polycarbonate*



Bulk Part No.	Display Part No.	Amps	Volts	A	B	C	D	Weight	Std. Pack
420842	420842-1	20 A	12 or 24	1-5/16"	1-7/16"	1-3/8"	7/8"	.04 lb	10 ea
420843	420843-1	30 A	12 or 24	1-5/16"	1-7/16"	1-3/8"	7/8"	.04	10 ea
420844	420844-1	40 A	12 or 24	1-5/16"	1-7/16"	1-3/8"	7/8"	.04	10 ea
420845	420845-1	50 A	12 or 24	1-5/16"	1-7/16"	1-3/8"	7/8"	.04	10 ea

Resettable inline circuit breaker with manual reset button for use with higher amperage accessories. Complies with SAE Standard J553. Splash proof. May be used on 12 volt or 24 volt systems.