

C36 - CONTROL CABLE FOR MERCURY® GENERATION II™ SERIES CONTROLS

- Direct replacement for Mercury® Gen. II™ cable
Part No. 883719 A "LL"
"LL" = length of the cable



CZERO HIGH EFFICIENCY AND FLEXIBILITY ENGINE CONTROL CABLE



FEATURES AND PERFORMANCE

- Suitable for outboard - inboard and sterndrive engines and all the Ultraflex controls.
- High efficiency for smooth operation.
- High flexibility for reduced bend radius. Ideal for long complex cable routings.
- Maintenance free.
- Stainless steel cable end fittings 10/32 UNF
- High resistance blue outer jacket against abrasion, UV and chemicals.



CZERO - EFFICIENCY COMPARISON TESTS

Tests configuration:
3 bends at 90° - 110 N load

NOTE: standard cable figures refer to average values obtained from samples bought from aftermarket sources.

■ CZero
■ Standard cable

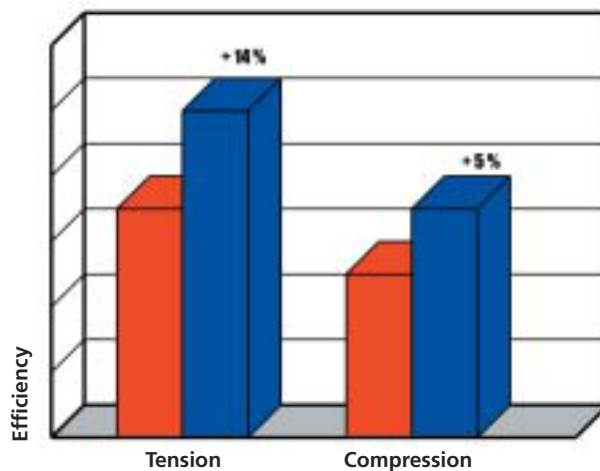

29



30

ENGINE CONTROL CABLES

HOW TO MEASURE FOR CONTROL CABLE INSTALLATION

FOR NEW INSTALLATION, measure A + B distance from the control along an unobstructed cable routing to clutch and / or throttle connection.

Round this dimension off to the next whole foot: you will have your cable length.

We recommend that the cable bends have a minimum radius of about 8" (200 mm).

For outboard engine installations, it is necessary to add three feet to the obtained length, in order to allow the engine movement.

To determine the needed length of the REPLACEMENT CABLE, measure it from tip to tip.

When ordering, specify the cable length in feet, rounding the dimension off to the next whole value.

If any kit is required to complete the cable connection, consult the appropriate section in this catalog.



OUTBOARD

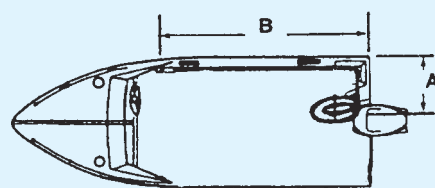

$$A + B + 3' (90 \text{ cm}) = L$$

INBOARD/STERNDRIVE

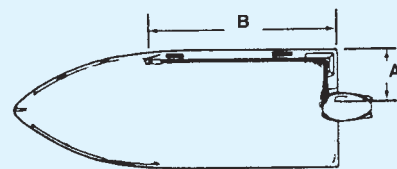

$$A + B = L$$

CONTROL CABLE CROSS REFERENCE

ULTRAFLEX	TELEFLEX® PART#	MORSE® PART#	APPLICATION
C2	UNIVERSAL CABLE CC172		YAMAHA®, SUZUKI®, HONDA®, NISSAN®, TOHATSU®, SELVA®
C8	MIRACABLE CC330 PREMIUM CC199	33C RED JACKET 32377-003	YAMAHA®, SUZUKI®, HONDA®, NISSAN®, TOHATSU®, SELVA®
CZero	TFXTRME CC223	33C SUPREME 301947-003	YAMAHA®, SUZUKI®, HONDA®, NISSAN®, TOHATSU®, SELVA®
C5	600A CC179	TYPE KM 637323	MERCURY®, MERCRIUSER®, MARINER® OVER 50 HP
C4	400 TYPE CC170	TYPE O 48296	PRE 1979 OMC®, EVINRUDE®, JOHNSON®
C14	479 TYPE CC205	TYPE OS 302029	1979 TO DATE OMC®, JOHNSON®, EVINRUDE®
C16	630 TYPE CC210		MARINER® UP TO 50 HP
C25	CC214	TYPE OC 310048	VOLVO® WITH OMC® CONTROLS
C22	STANDARD 4300 TYPE CC193	43C REDLINE 65835-003	HEAVY DUTY APPLICATIONS INBOARDS AND JETS
C23 BC	BULKHEAD 4300 TYPE CC192	43BC REDLINE 46348-003	HEAVY DUTY APPLICATIONS INBOARDS AND JETS
C36			MERCURY GENERATION II CONTROLS

ENGINE CONTROL CABLES

- C2** Stroke: 3.4" (87 mm)
For use with inboard, sterndrive and outboard engines with appropriate accessories.
- C8** Stroke: 3.4" (87 mm)
For inboard, sterndrive, outboard engines, with appropriate accessories.
- CZero** Stroke: 3.4" (87 mm)
For inboard outboards, inboards and outboards.
Ideal for high performance applications and long cable runs and complex routings. Blue color jacket.
- C4** Stroke: 3.1" (80 mm)
For Johnson®, Evinrude®, OMC® engines manufactured before 1979.
- C14** Stroke: 3" (75 mm)
For Johnson®, Evinrude®, OMC® engines manufactured after 1979.
- C5** Stroke: 3.75" (95 mm)
For Mercury® and Mercruiser® engines and 1993 to date Force Mariner®.
- C36** Stroke: 3.3" (85 mm)
For Mercury® and Mercruiser® engines and Mercury® Generation II™ series controls.
- C16** Stroke: 3.1" (80 mm)
For Mariner® engines up to 37 kW (50hp).
- C25** Stroke: 3.1" (80 mm)
For Volvo® engines using OMC® top mount controls.
- C22** Stroke: 3.1" (80 mm)
Stainless steel clamp fittings. Recommended for heavy duty applications.
- C23BC** Stroke: 3.1" (80 mm)
Bulkhead mount 4300 type cable
Stainless steel clamp fitting and bulkhead fitting recommended for heavy duty applications.
- B14** Stroke: 2.8" (70 mm)
Designed for throttle, fuel shut-off and other applications. Supplied with L13 and L14 clamp and shim.

Part number for ordering:
Example: C2 XLL - LL = Length

UNIVERSAL 3300 STYLE CABLES

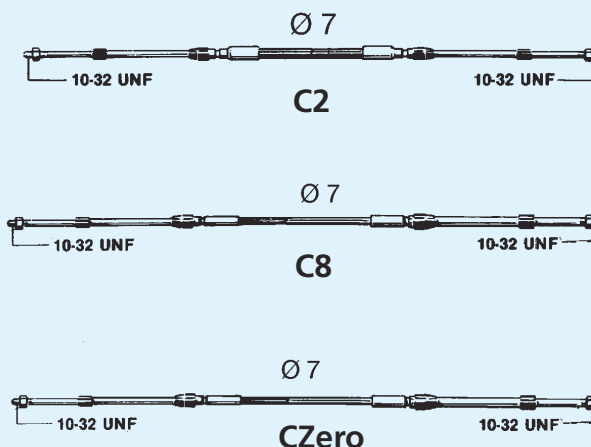

OMC® - JOHNSON® - EVINRUDE® CABLES

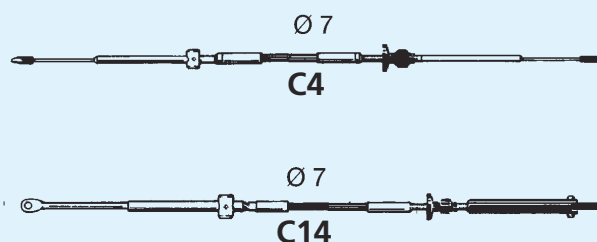

MERCURY® - MERCURUISER® - MARINER® - VOLVO® CABLES

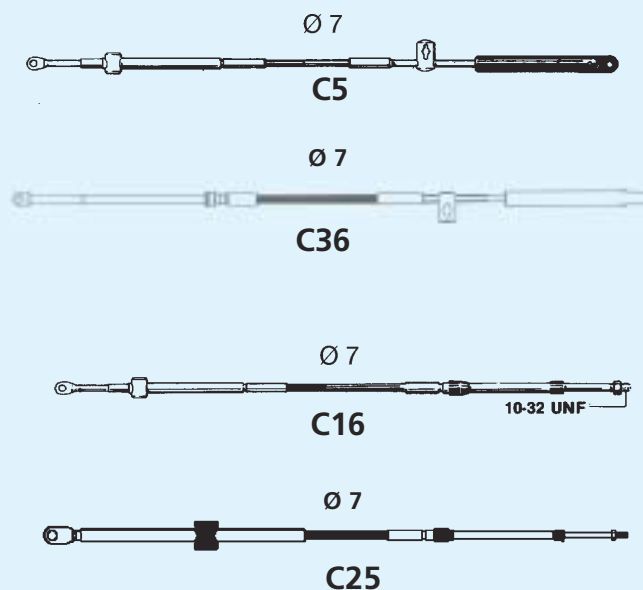

UNIVERSAL 4300 STYLE CABLES

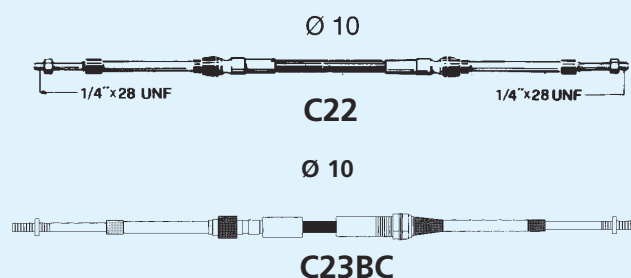

ENGINE STOP CABLE

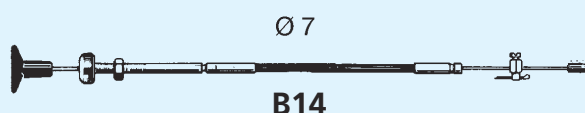

31

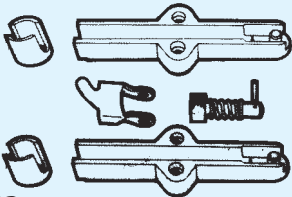

K23

ACCESSORIES FOR ENGINE CONTROL CABLES

L2 - 30324 D

Cable clamp block

L3 - 30325 E

Shim and clamp block.

Fits C2, C8, Czero and all 33C style cables.

L7 - 38078 U

Ball joint 10-32 UNF.

Stainless steel, fits C2, C8, Czero and all 33C style cables.

L12 - 30334 F

Cable end fitting.

Fits C2, C8, Czero and all 33C style cables.

L13 - 30335 G

Stop collar. Fits C4 and B14 cables.

L14 - 30336 H

Cable clamp block.

Fits C2, C8, Czero and all 33C style cables.

L25 - 31906 D

Clevis 10-32 UNF.

Fits C2, C8, Czero and all 33C style cables.

L26 - 33517 N

Clevis 1/4" x 28 threaded. Fits C22 and 4300 series cables.

K56 - 39237 C

Adapts C2, C8, Czero and all 33C style cables for use with Mercury® engines.

K57 - 39238 E

Adapts C2, C8, Czero and all 33C style cables for use with Johnson® / Evinrude® engines.

L2



L3

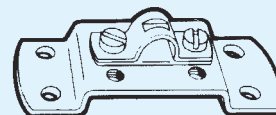

L7

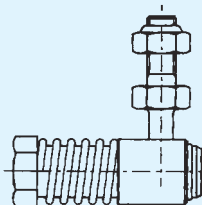

L12



L13

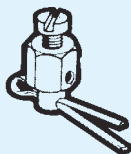

L14

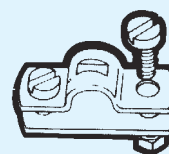

L25

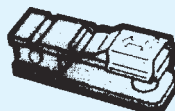

L26

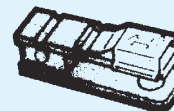

K56

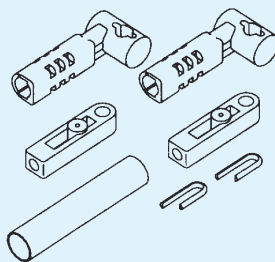

K57

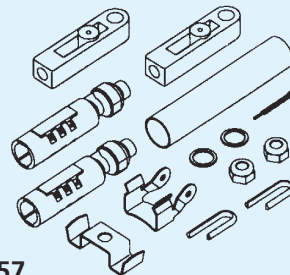

33