

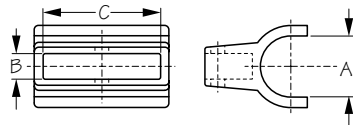

## RAIL MOUNT BOW SOCKET

*Injection Molded Nylon*



*Made In USA*

Bulk Part No.	Display Part No.	A	B	C	Weight	Std. Pack
327400	n/a	7/8"	3/8"	1-11/16"	.04 lb	10 ea
n/a	327400-1	7/8"	3/8"	1-11/16"	.08	10 pr

Designed to fit snugly on a 7/8" round rail without the use of fasteners. The Rail Mount Bow Sockets aid in assembling a rounded support structure for a cover and can be easily removed from the boat when the cover is not in use.