

# INSTRUCTION SHEET

## Gearcase Alignment Gauge Kit, P/N 5006349

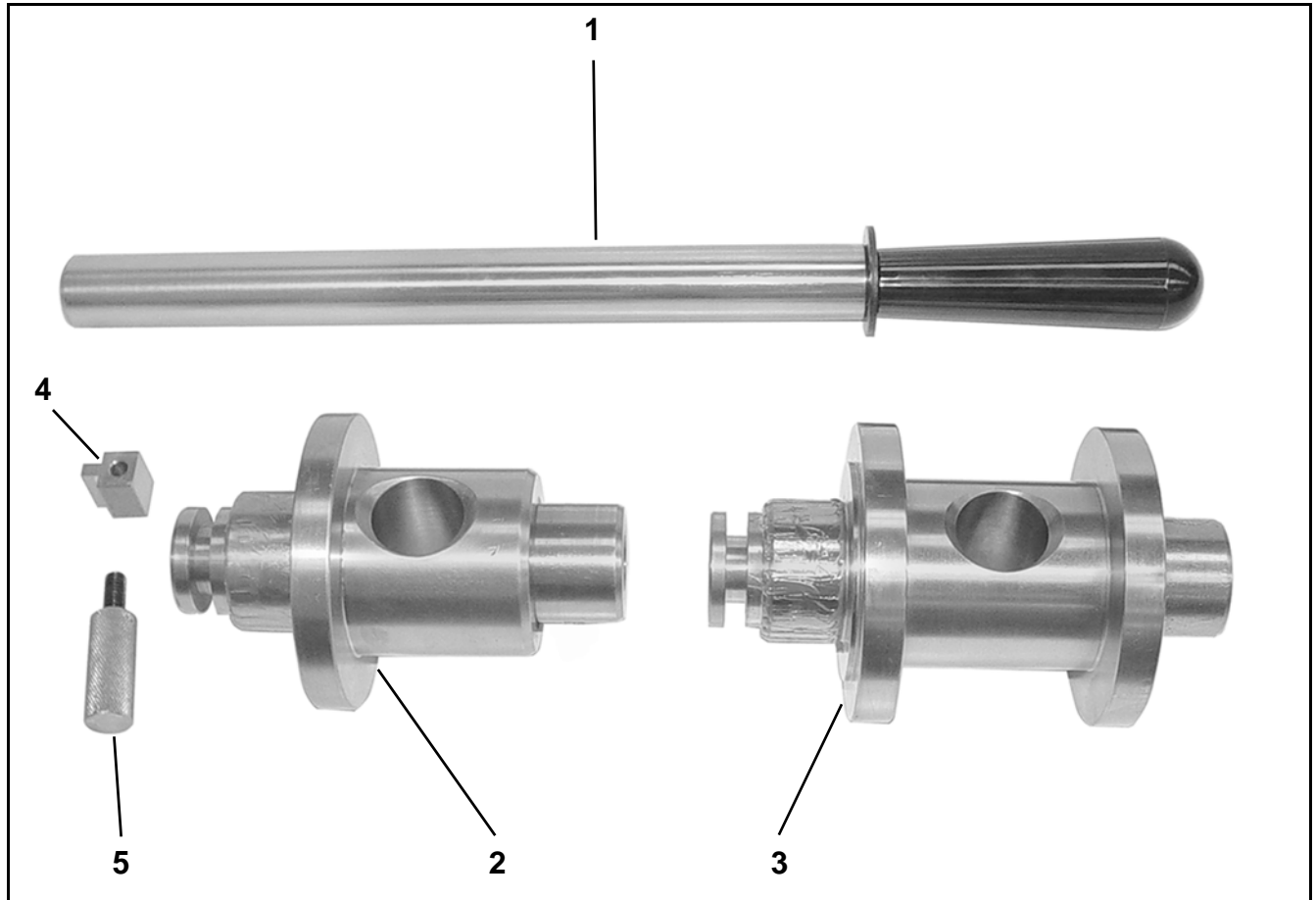

### Contents of Gearcase Alignment Gauge Kit, P/N 5006349

1. Gauging bar
2. Gauging head, "O" type, "L" type and 1979 and newer
3. Gauging head, "M" type and "XP" type
4. Retainer
5. Thumb screw

A new service tool has been developed for servicing *Evinrude* and *Johnson* outboards. Use Gearcase Alignment Gauge Kit, P/N 5006349 to check the condition of all late model V6 gearcase housings prior to reassembly.

This gauge kit assembles to the forward bearing housing of a standard rotation gearcase and driver handle, P/N 311880 (existing tool). Assemble as indicated to check all V6 gearcase housings (1979 and newer, "O" and "L" types; and "M" and "XP" types).

**IMPORTANT:** Disassemble and thoroughly clean gearcase housing and reinstall pinion bearing prior to installing the assembled gearcase alignment gauge into gearcase housing.

## INSTRUCTIONS

Assemble gauging head with forward thrust bearing and washer onto forward bearing housing with retainer and shift pin. Thread driver handle into back of gauging head and tighten. Position reverse thrust bearing and washer on gauging head.

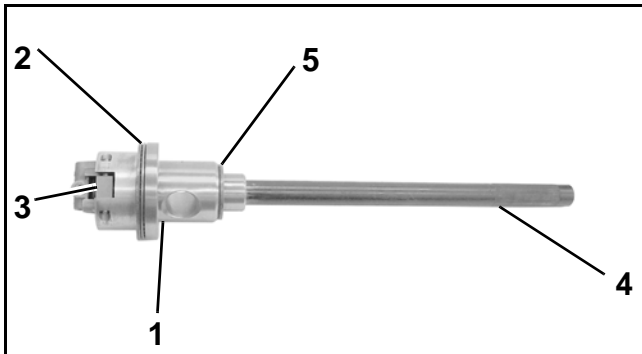

1. Gauging head
2. Forward thrust washer and bearing
3. Retainer
4. Driver handle, P/N 311880
5. Reverse thrust bearing and washer

Insert assembly into cleaned gearcase housing. Make sure that forward bearing housing seats completely into front of gearcase housing.

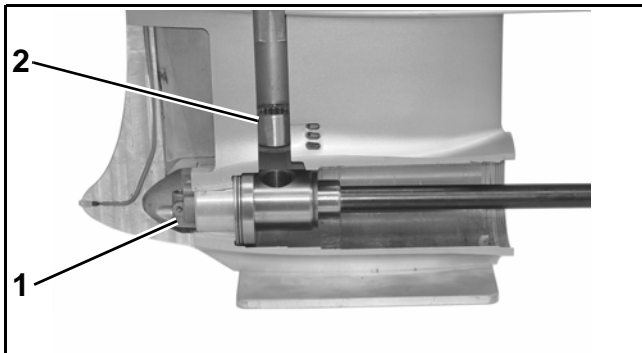

1. Forward bearing housing
2. Pinion bearing, assembled

Temporarily install the propeller shaft bearing housing **without** large orings (or locking wedge if equipped). Bearing housing must be fully seated in gearcase housing. Install lower tab retainer in housing and secure with thumb screw (if equipped).

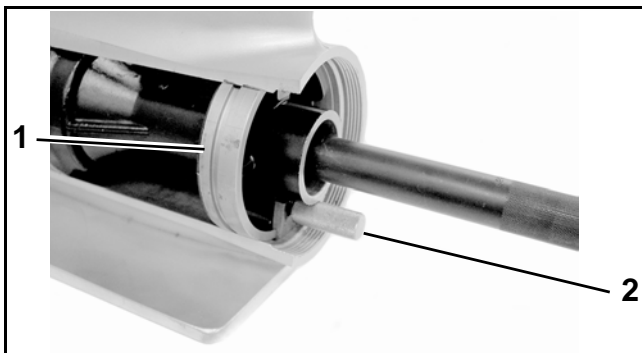

1. Bearing housing
2. Thumb screw

Temporarily install driveshaft bearing housing **without** seals and oring into gearcase housing and secure with two (2) screws. Bearing housing must be fully seated in gearcase housing.

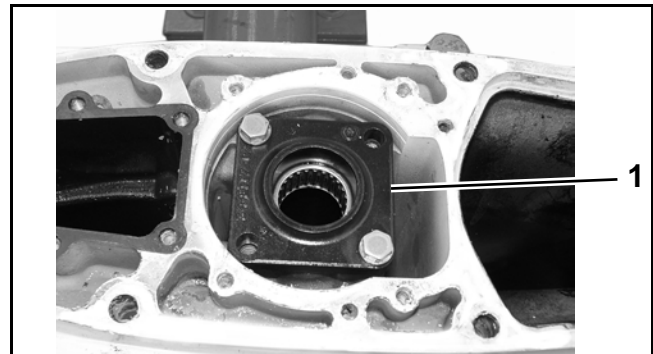

1. Driveshaft bearing housing

Use driver handle to turn gauging head as needed. Position gauging head to allow gauging shaft to slide easily into alignment hole in gauging head.

**IMPORTANT:** DO NOT force shaft into alignment hole. Shaft **MUST** slide easily into hole of gauging head. If shaft does not slide into hole, gearcase housing is damaged and **must** be replaced.

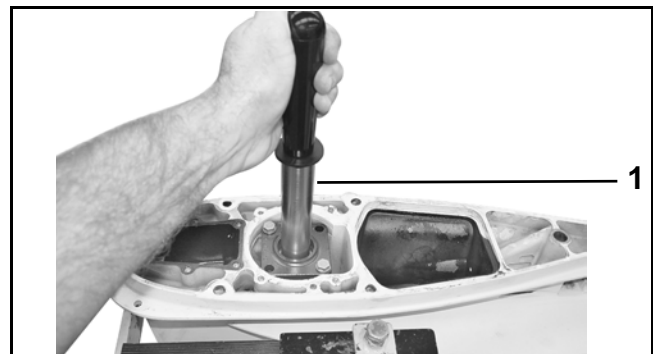

1. Gauging shaft

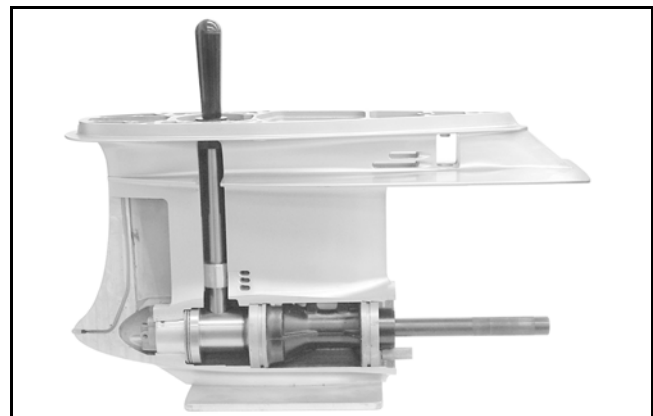

- Assembled Cutaway View