

14360A78

FUEL PUMP REPLACEMENT KIT

⚠ WARNING

Use caution when changing fuel pump; gasoline is extremely flammable and highly explosive under certain conditions. Be sure electrical source to engine is disconnected. Do not smoke or allow sources of spark or open flame in area when installing kit. Wipe up any spilled fuel immediately.

Components Contained in Kit

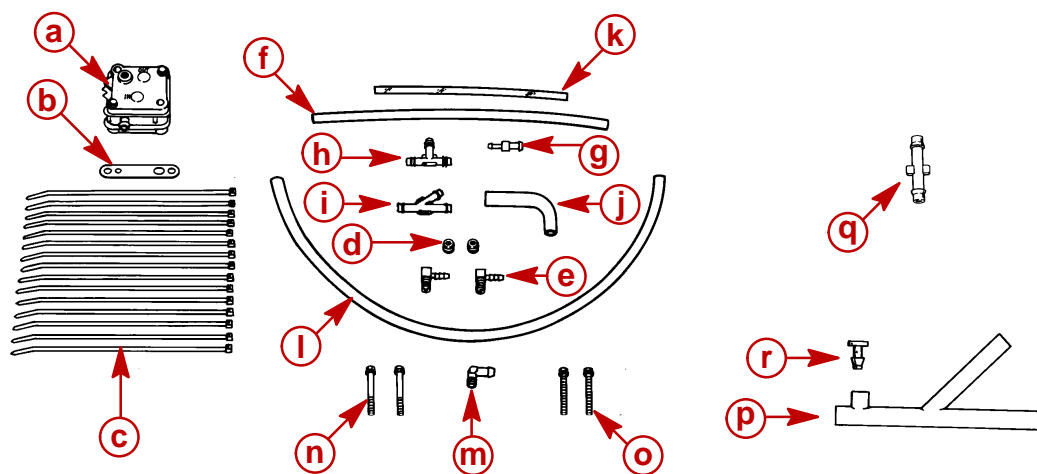

Ref.	Description	Qty.
a	Fuel Pump	1
b	Gasket (27-98769--1)	1
c	Sta-Strap (54-816311)	12
d	Plug (22-39072)	2
e	Hose Connector (22-43335)	2
f	Hose, 26 in. (660mm) Bulk (32-99128)	1
g	Check Valve (22-818994--1)	1
h	T-Connector (22-818993)	1
i	Y-Connector (22-818992)	1
j	Molded Hose (32-18175)	1
k	Clear Tubing, 15 in. (380mm) Bulk (32-823813-35)	1
l	Hose, 70 in. (1.8m) Bulk (32-830757130)	1
m	90 Degree Elbow (22-99664--1)	1
n	Screw, M6x1x50 (10-817541-50)	2
o	Screw, #12-24x2.00 (10-16452)	2
p	Molded Hose (32-822554)	1
q	Connector (22-822771)	1
r	Plug (19-822772)	1

IMPORTANT: Not all components contained in this kit apply to each engine. Insure that those components which are applicable to a particular engine are installed and that similar existing parts on the engine are discarded.

IMPORTANT: Secure all hose connections with sta-straps provided, or their equivalent.

IMPORTANT: After installing new fuel pump, while priming fuel system prior to initial start, inspect all fuel connections for leakage.

Installation Instructions

Model 35 HP (2 CYL.)

NOTE: New fuel pump base must be removed (and discarded) before installing new pump on powerhead. Use existing attaching screws to secure new pump to powerhead.

1. Components applicable in kit:
 - a. Fuel Pump
 - b. Sta-strap (54-816311)
 - c. Hose [70 in. (1.8m)] (32-830757130) Cut to appropriate length
 - d. 90 Degree Elbow (22-99664--1)

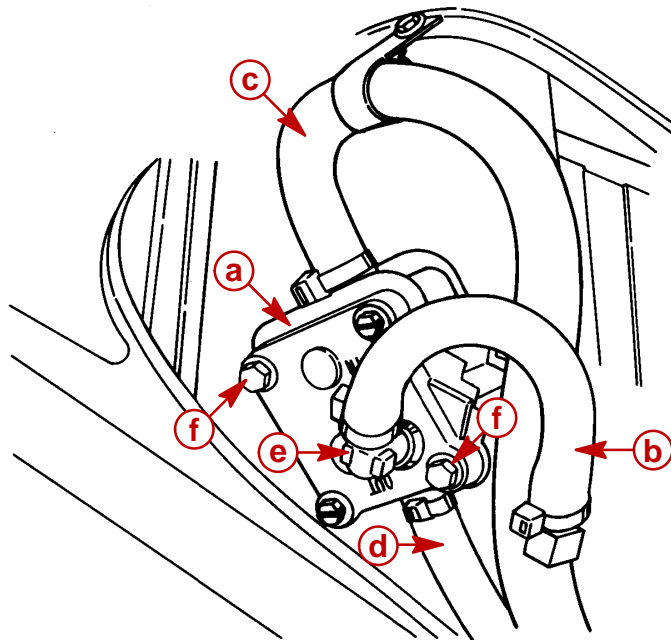

51517

- a** - Fuel Pump
- b** - Pulse Hose
- c** - Inlet Hose
- d** - Outlet Hose
- e** - Elbow [Apply PERFECT SEAL (92-34227--1) to threads]
- f** - Screws [Torque to 55 lb. in. (6.2 N·m)]

Model 40 (4 Cyl.)

1. Components applicable in kit:
 - a. Fuel Pump
 - b. Gasket (27-98769--1)
 - c. Sta-strap (54-816311)
 - d. Plug (22-39072)
 - e. Hose [70 in. (1.8m)] (32-830757130) Cut to appropriate length
 - f. Screw, #12-24 x 2.00 (10-16452) (2 each)

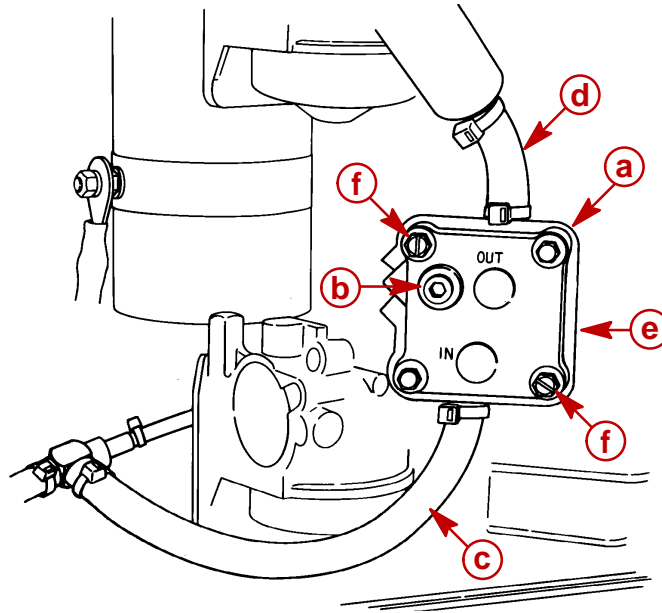

51518

- a** - Fuel Pump
- b** - Plug [Apply PERFECT SEAL (92-34227--1) to threads]
- c** - Inlet Hose
- d** - Outlet Hose
- e** - Gasket (Cylinder Block to Fuel Pump) (HIDDEN)
- f** - Screws [Torque to 55 lb. in. (6.2 N·m)]

Model 45 (4 Cyl.)

1. Components applicable in kit:
 - a. Fuel Pump
 - b. Gasket (27-98769--1)
 - c. Sta-strap (54-816311)
 - d. Plug (22-39072) (2 each)
 - e. Hose [70 in. (1.8m)] (32-830757130) Cut to appropriate length
 - f. Screw, #12-24 x 2.00 (10-16452) (2 each)

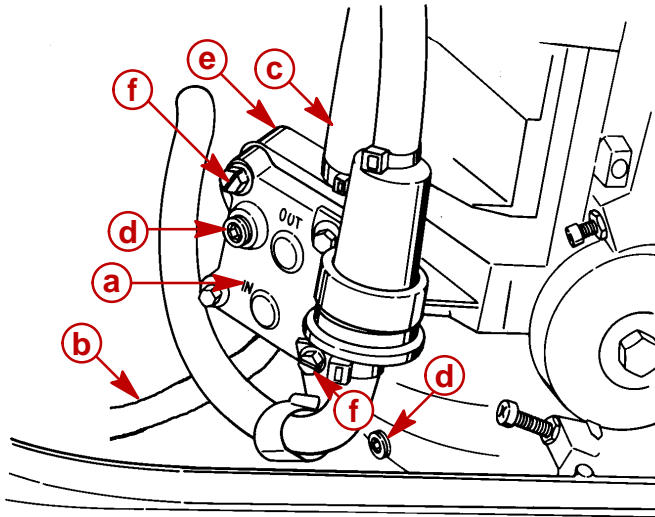

51518

- a** - Fuel Pump
- b** - Inlet Hose
- c** - Outlet Hose
- d** - Plug [Apply PERFECT SEAL (92-34227--1) to threads]
- e** - Gasket (Cylinder Block to Fuel Pump) (HIDDEN)
- f** - Screws [Torque to 55 lb. in. (6.2 N·m)]

Model 50 and 60 (3 Cyl. 49.3 Cu. In.)

NOTE: New fuel pump base must be removed (and discarded) before installing new pump on powerhead. Use existing attaching screws to secure new pump to powerhead.

1. Components applicable in kit:
 - a. Fuel Pump
 - b. Gasket (27-98769--1)
 - c. Sta-strap (54-816311)
 - d. Molded Hose (32-18175)
 - e. Hose [70 in. (1.8m)] (32-830757130) Cut to appropriate length
 - f. 90 Degree Elbow (22-99664--1)

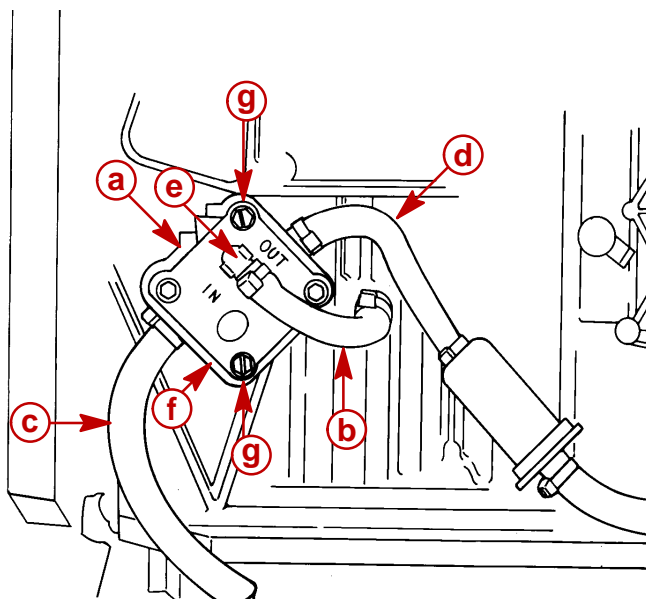

51517

- a** - Fuel Pump
- b** - Pulse Hose
- c** - Inlet Hose
- d** - Outlet Hose (Replace with Molded Hose – Trim fuel pump end of molded hose to provide better fit)
- e** - Elbow [Apply PERFECT SEAL (92-34227--1) to threads]
- f** - Gasket (Cylinder Block to Fuel Pump) (HIDDEN)
- g** - Screws [Torque to 55 lb. in. (6.2 N·m)]

Model 50 and 60 (3 Cyl. 51.8 Cu. In.)

1. Components available in kit:
 - a. Fuel Pump
 - b. Gasket (27-98769--1)
 - c. Sta-strap (54-816311)
 - d. Hose Connector (22-43335) (2 each) Note: Pre-1992 models require this smaller diameter connector; 1992 models have this connector already installed.
 - e. Hose For new pulse hose [26 in. (660mm)] (32-991281-78) Cut to appropriate length
 - f. Hose [70 in. (1.8m)] (32-830757130) Cut to appropriate length
 - g. Screws (M6 x 1 x 50) (10-817541--50) (2 each)

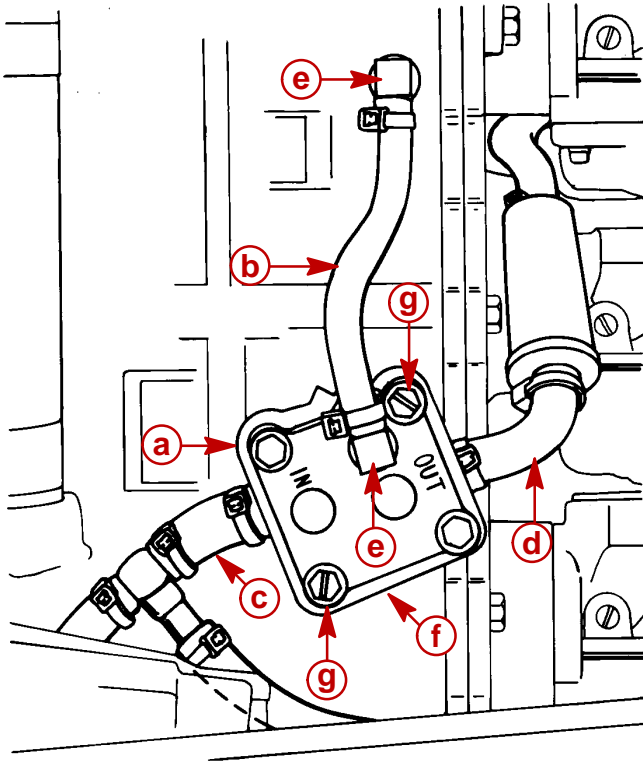

51519

- a** - Fuel Pump
b - Pulse Hose
c - Inlet Hose
d - Outlet Hose
e - Hose Connector (2 each) [Apply PERFECT SEAL (92-34227--1) to threads]
f - Gasket (Cylinder Block to Fuel Pump) (HIDDEN)
g - Screws [Torque to 55 lb. in. (6.2 N·m)]

Model 70,75,80,90 (3 Cyl. 71.1 Cu. In.) and 100,115 (4 Cyl. 105 Cu. In.)

IMPORTANT: After installation of kit, secure inlet fuel hose to attenuator box with sta-strap to prevent interference of fuel hose with linkage.

1. Components applicable in kit:
 - a. Fuel Pump
 - b. Gasket (27-98769--1)
 - c. Sta-strap (54-816311)
 - d. Check Valve (22-818994--1)
 - e. Molded Hose (32-822554)
 - f. Plug (19-822772)
 - g. Clear Tubing [15 in. (380mm)] (32-823813-35)
 - h. Hose [70 in. (1.8m)] (32-830757130) Cut to appropriate length
 - i. 90 Degree Elbow (22-99664--1)
 - j. Screws (M6 x 1 x 50) (10-817541--50) (2 each)
 - k. Molded Hose (32-18175)

Model 70, 75, 80, 90

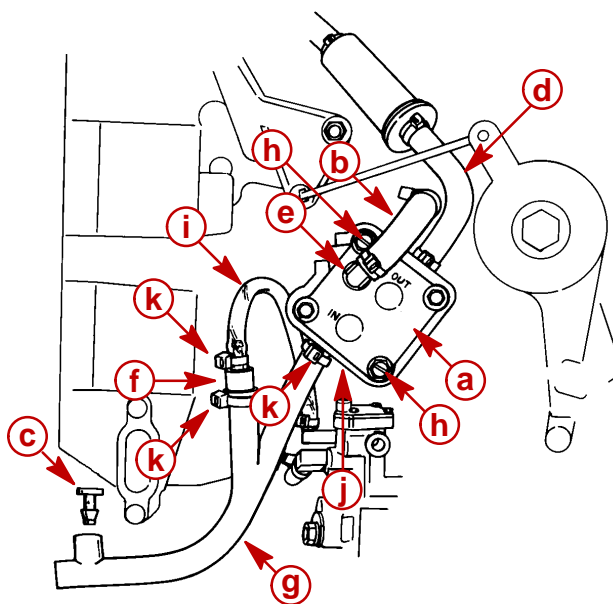

51689A

- a** - Fuel Pump
- b** - Pulse Hose
- c** - Plug
- d** - Outlet Hose (Replace with Molded Hose)
- e** - Elbow [Apply PERFECT SEAL (92-34227--1) to threads]
- f** - Check Valve
- g** - Molded Hose
- h** - Screws [Torque to 55 lb. in. (6.2 N·m)]
- i** - Clear Tubing [5.5 in. (139.7mm)]
- j** - Gasket (Cylinder Block to Fuel Pump) (HIDDEN)
- k** - Sta-strap Securing Inlet Fuel Hose to Attenuator

Model 70, 75, 80, 90

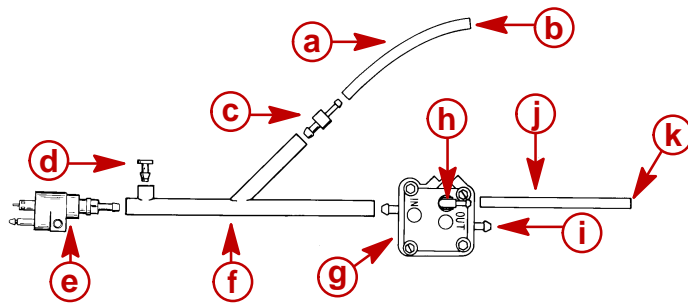

51689D

- a** - Clear Tube [5.5 in. (139.7mm)]
- b** - To Oil Pump Outlet
- c** - Check Valve
- d** - Plug
- e** - Fuel Line Connector
- f** - Molded Hose
- g** - Fuel Pump
- h** - 90 Degree Elbow
- i** - Fuel Outlet to Filter
- j** - Hose [2.5 in. (63.5mm)]
- k** - To Pulse Fitting on Powerhead

Model 100, 115

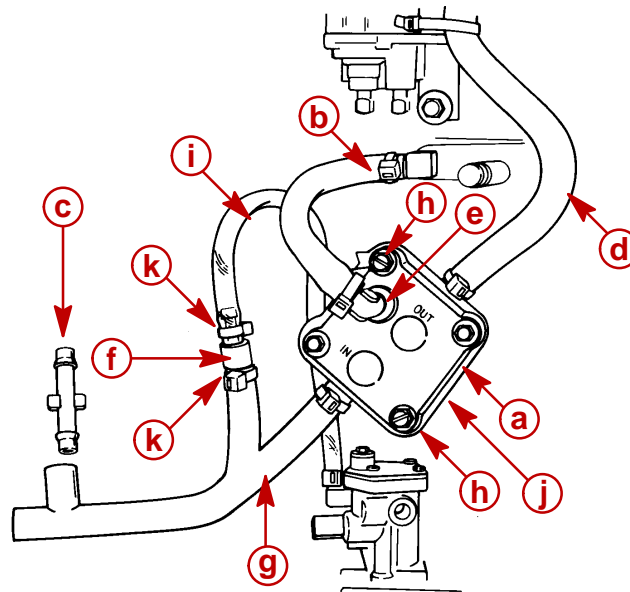

51689C

- a** - Fuel Pump
- b** - Pulse Hose
- c** - Connector
- d** - Outlet Hose
- e** - Elbow [Apply PERFECT SEAL (92-34227--1) to threads]
- f** - Check Valve
- g** - Molded Hose
- h** - Screws [Torque to 55 lb. in. (6.2 N·m)]
- i** - Clear Tubing [8 in. (203.2mm)]
- j** - Gasket (Cylinder Block to Fuel Pump) (HIDDEN)
- k** - Sta-strap Securing Inlet Fuel Hose to Attenuator

Model 100, 115

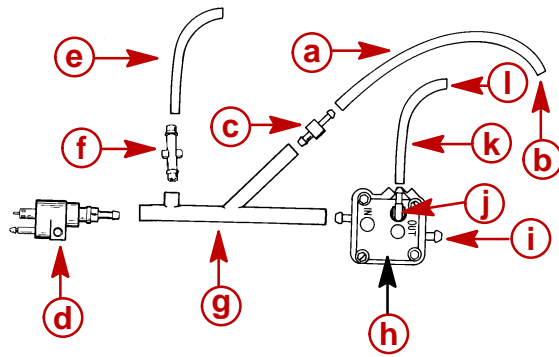

51689D

- a** - Clear Tube [8 in. (203.2mm)]
- b** - Oil Pump Outlet
- c** - Check Valve
- d** - Fuel Connector
- e** - Hose
- f** - Connector
- g** - Molded Hose
- h** - Fuel Pump
- i** - Fuel Outlet
- j** - 90 Degree Elbow
- k** - Hose
- l** - To Pulse Fitting on Powerhead

Model 115 (6 Cyl.)

1. Components available in kit:
 - a. Fuel Pump
 - b. Gasket (27-98769--1)
 - c. Sta-strap (54-816311)
 - d. Hose [70 in. (1.8m)] (32-830757130) Cut to appropriate length
 - e. 90 Degree Elbow (22-99664--1)
 - f. Screws, #12-24 x 2.00 (10-16452) (2 each)

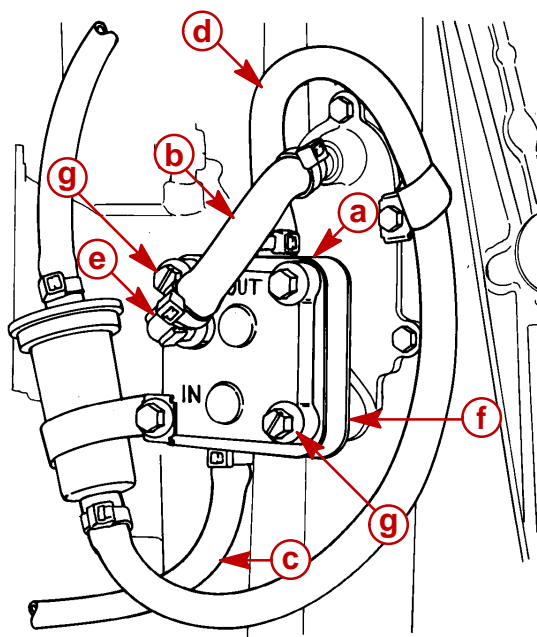

51518

- a** - Fuel Pump
- b** - Pulse Hose
- c** - Inlet Hose
- d** - Outlet Hose
- e** - Elbow [Apply PERFECT SEAL (92-34227--1) to threads]
- f** - Gasket (Cylinder Block to Fuel Pump) (HIDDEN)
- g** - Screws [Torque to 55 lb. in. (6.2 N·m)]

Model 1992 2.5 Litre V-6

1. Components applicable in kit:
 - a. Fuel Pump
 - b. Gasket (27-98769--1)
 - c. Sta-strap (54-816311)
 - d. Check Valve (22-818994--1)
 - e. T-Connector (22-818993)
 - f. Molded Hose (32-18175)
 - g. Clear Tubing [15 in. (380mm)] (32-823813-35) Cut to appropriate length
 - h. Hose [70 in. (1.8m)] (32-830757130) Cut to appropriate length
 - i. 90 Degree Elbow (22-99664--1)
 - j. Screws, M6 x 1 x 50 (10-817541--50) (2 each)

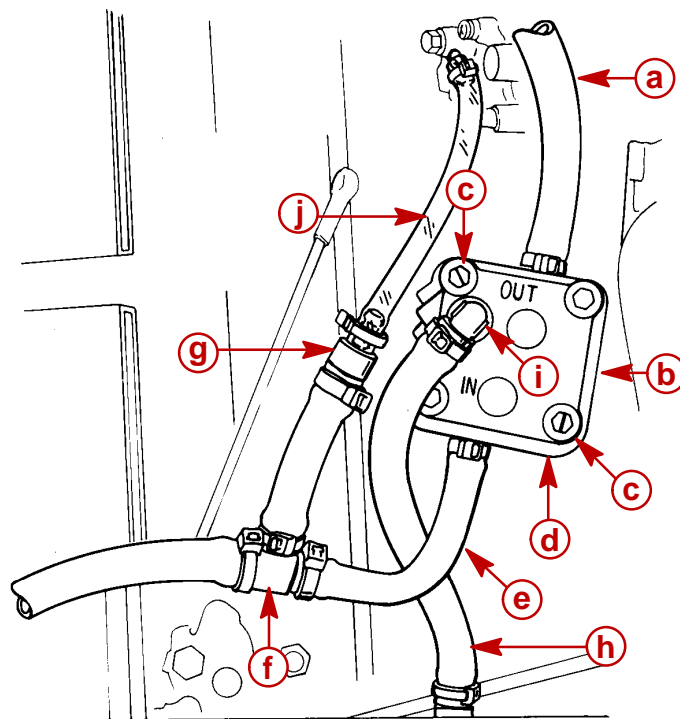

51517

- a** - Outlet Hose
- b** - Fuel Pump
- c** - Screws [Torque to 55 lb. in. (6.2 N·m)]
- d** - Gasket (Cylinder Block to Fuel Pump) (HIDDEN)
- e** - Inlet Hose
- f** - T-Connector
- g** - Check Valve
- h** - Pulse Hose
- i** - Elbow [Apply PERFECT SEAL (92-34227--1) to threads]
- j** - Clear Tubing

Model 300, 3.4L, 250, 275 (207 Cu. In.)

1. Components applicable in kit:
 - a. Fuel Pump
 - b. Gasket (27-98769--1)
 - c. Sta-strap (54-816311)
 - d. Hose [70 in. (1.8m)] (32-830757130) Cut to appropriate length
 - e. 90 Degree Elbow (22-99664--1)
 - f. Screws, #12-24 x 2.00 (10-16452) (2 each)

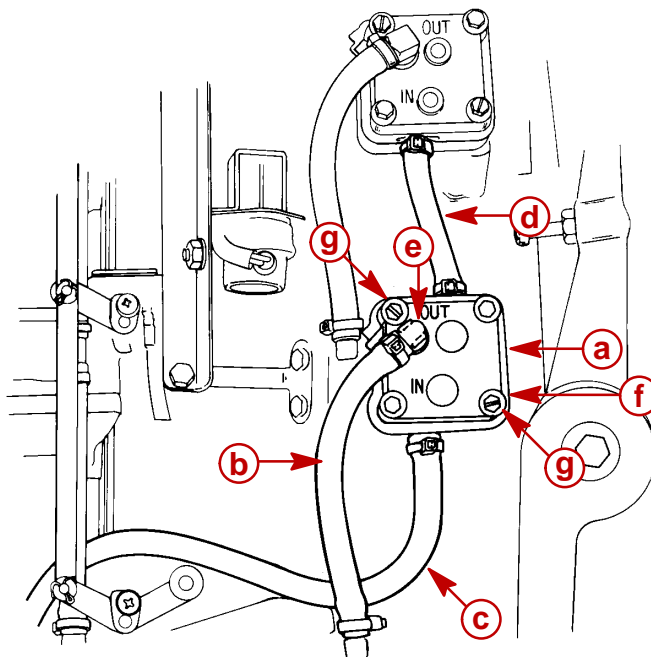

51517

- a** - Fuel Pump
- b** - Pulse Hose
- c** - Inlet Hose
- d** - Outlet Hose
- e** - Elbow [Apply PERFECT SEAL (92-34227--1) to threads]
- f** - Gasket (Cylinder Block to Fuel Pump) (HIDDEN)
- g** - Screws [Torque to 55 lb. in. (6.2 N·m)]