

SHIELDS HOSE Exhaust/Clamps

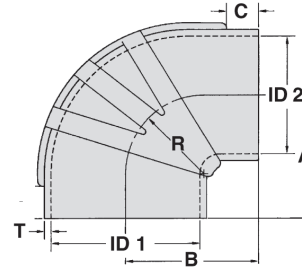

90° Reducing Elbow

Part Number	ID1	ID2	A	B	C	D	R	T
16-291-500x400	5.50	4.00	8.00	3.63	1.25	2.25	.20	
16-291-600x500	6.00	5.00	5.00	5.00	1.50	1.50	3.50	.25

EXHAUST PROTECTOR VALVES



Specially Compounded Rubber Flapper Valves Designed To Prevent Water From Entering The Exhaust System In Following Seas Or When Backing Down.

Made with weather resistant EPDM with U/V stabilizer.

18-#'s include stainless steel hose clamp.

N-#'s are bulk flappers only

Code #	Pipe Size	O.E.M.	O.E.#
18-4456*	3"	Mercury	34765A1
18-4457*	4"	Mercury	12644A1
18-4458*①	5" or 6"	—	—
N-184456	3"	—	—
N-184457	4"	—	—
N-184458①	5" or 6"	—	—

* Display Packaged

① Must be cut at marks to fit 5" pipe



HEAVY DUTY EXHAUST HOSE CLAMPS

- * 3/4" wide t-bolt band clamp
- * Exhaust hose clamp
- * Beveled edges will not damage hose

- * Band 3/4" W x 0.031" T 304 SS
- * Hardware SS 302 5/16 "T" bolt w/ SS Nylon insert lock nut
- * Full 360 clamping surface
- * Starting torque at 25 in-pounds and torque to 75 in-pounds maximum
- * Large clamps are double bolt for maximum adjustment

Designed to fit Shields series 200, 202, 205, 250, 255, 252, 257 262 exhaust hoses

Code No.	Diameter Range		Hose I.D.	Wt. C
	Min	Max		
18-730-4000	4.18	4.84	4"	33.2
18-730-4120	4.68	5.34	4 1/2"	34.6
18-730-5000	5.18	5.84	5"	35.2
18-730-5120	5.68	6.34	5 1/2"	36.7
18-730-6000	6.18	6.84	6"	37.3
18-730-8000*	8.18	9.50	8"	66.2
18-730-10000*	10.18	11.50	10"	70.5
18-730-12000*	12.18	13.50	12"	74.7
18-730-14000*	14.30	15.50	14"	79.8

* Double bolt

